

A unique, space saving tool for server administrators and technicians

Portable KVM to USB Mobile Console Laptop Adapter

When a "headless" server goes down, a direct physical connection is often required. This usually means hauling around bulky crash carts, monitors, PCs, keyboards, mice, batteries, and searching for power outlets. Now with the pocket-sized Mobile Console adapter, all you need is your laptop!

Who needs the Mobile Console Adapter?

- Server technicians and administrators of:
 - Web hosting facilities and co-location operations
 - Small and medium businesses with local or distributed servers.
- Especially useful for:
 - ATM's, Video Lottery Terminals
 - Government and private kiosks
 - Medical and laboratory equipment

Benefits for the user:

- Fits easily in a pocket or laptop bag
- High speed, instant on feature, ensuring the technician sees the BIOS every time.
- Does not drain power from your laptop - no outlet required
- Connects to any type of USB or PS/2 Computer
- Even works with most netbooks (Windows, Mac OS 10+)



NOTECONS01

Comparison Matrix

Feature	StarTech.com KVM to USB Mobile Console Adapter	Old fashioned crashcart	KVM over IP device	Remote desktop / VNC software
Fits in your pocket	Yes	No	No	N/A
Self powered from server	Yes	No	No	N/A
Maximum resolution @ 30fps	1920 x 1200	Variable	Low	Low
Recovery access to BIOS	Yes, instant on	Yes	With additional hardware	No
VGA Frame grabber	Yes	No	No	No
Real-time video scaling	Yes	No	No	No
Native USB	Yes	Yes	Yes	N/A

How it Works

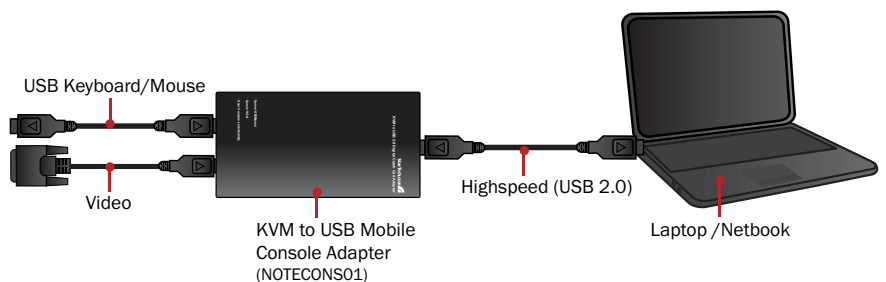
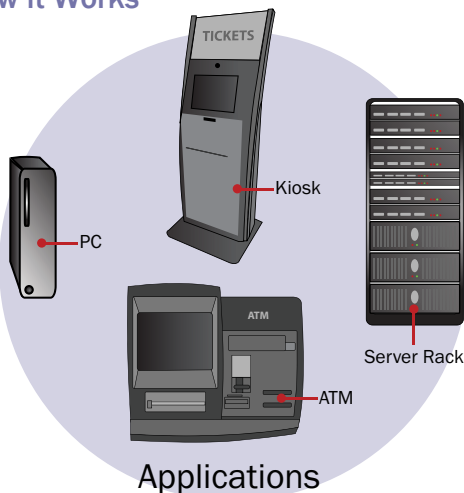

★★★★★/5

"...Could be exceptionally useful to IT professionals and network administrators that don't always have the convenience of an external display and keyboard."

electronista
gadgets for geeks



NOTECONS01

Detailed Specifications

Connections

- Inputs: Analog VGA video, USB keyboard and mouse (single connector), cables attached.
- Outputs: High-speed USB video (480Mbps) to laptop. Female Mini-B connector. 6ft detachable cable included.
- Indicators: Server USB/Mouse connection, server VGA connection, user console (Laptop) Link/Activity.
- Power: Shares USB power from laptop and/or host.
- A passive PS/2 to USB adapter (included) provides PS/2 keyboard access to older systems. Does not support the use of a PS/2 mouse.

Software Features

- Max video resolution: 1920x1200 @ 60Hz or 1600x1200 @ 75Hz.
- Video scaling modes: any scale from 6% to 100% (in 6.25% steps), full screen mode (uses all pixels of your laptop), maximized mode (laptop taskbar is accessible).
- Resize the video image just by resizing window. The entire video picture is always visible - without scroll bars.
- Video adjustments: fine position control (image centering), sample phase (sharpness), video noise filtering controls.
- Special keys: easily send Alt+F4, Ctrl-Alt-Del and other key sequences that would otherwise affect the laptop instead of the server.
- Functions as a screen grabber (PNG & JPEG).

Laptop Requirements

- Windows 2000, XP or Vista (32-bit & 64-bit).
- Mac OS X 10.5 (Leopard) or higher. Intel only.
- One available high-speed USB port on laptop. 100mA current.
- 20 Megabytes available disk space for install. 24-bit colour display.

Server Requirements

- One USB port 1.1 or 2.0 for keyboard and mouse. 500mA current. (PS/2 Keyboard port can be used with included adapter)
- Analog VGA graphics output. Analog DVI can be used with adapter.
- Operating system which supports absolute USB mouse: Windows 2000 and up, Mac OS, etc.

Mechanical / Approvals

- Size w/d/h: 74mm x 115mm x 15mm (2.9" x 4.5" x 0.6")
- Weight: 170g
- Power: max 500mA at 5 VDC
- FCC Class A, CE Approved, RoHS

Environmental

- Operating: 0C to 40C/32F to 104F, 80% rh, nc
- Storage: -40C to 70C/-40F to 158F

Part Numbers

NOTECONS01	KVM to USB Mobile Console Adapter
USB2HABM10	Optional 10ft USB Cable
DVIVGAMF	Optional DVI Female to VGA Male adapter

*Specifications are subject to change