

2 Port Professional USB DisplayPort KVM Switch with Hotkey Control

StarTech ID: SV231DPU



This 2-Port USB DisplayPort KVM Switch combines the next generation of digital display interface standards with seamless KVM control of connected PC or Mac computers.

Delivering ideal multi-computer control for demanding high-resolution multimedia applications, or computer environments requiring true high definition capability, the robust KVM switch supports DisplayPort connections with a native resolution of 2560 x 1600 (@60 Hz, 30 bpp), as well as 7.1 HD digital audio (when connected to supporting displays and sources).

Suitable for applications that utilize high quality static imaging, such as medical/health care applications (MRI, X-ray diagnostics etc.), the KVM switch supports a maximum resolution of 3840 x 2400 at a reduced refresh rate.

Adding cost-effective performance to cutting-edge multimedia capability, this versatile KVM switch features three Plug-and-Play USB console ports, including two dedicated peripheral (mouse and keyboard) ports and one USB 2.0 hub port - enabling users to share a USB mouse and keyboard, and one USB 2.0 peripheral between the two connected Mac or PC computers.

A simple, yet comprehensive control solution, the 2-port KVM switch features both front-panel push-button and convenient hotkey switching and offers a small form factor design with connection ports situated on the rear panel, allowing you to eliminate workspace disruptions.

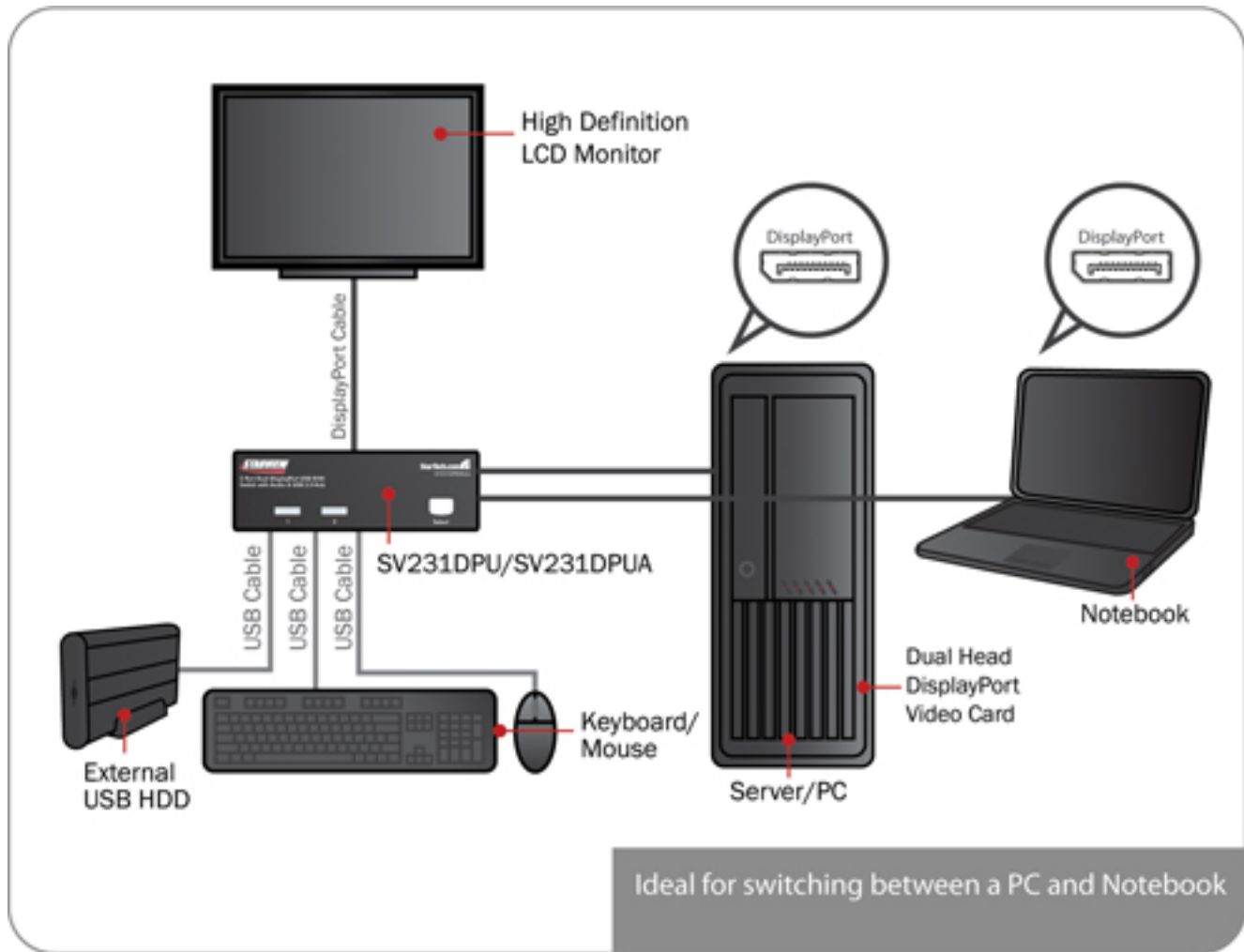

The SV231DPU DisplayPort KVM switch is backed by our 3-year warranty and free lifetime technical support, guaranteeing dependable, long-lasting performance.

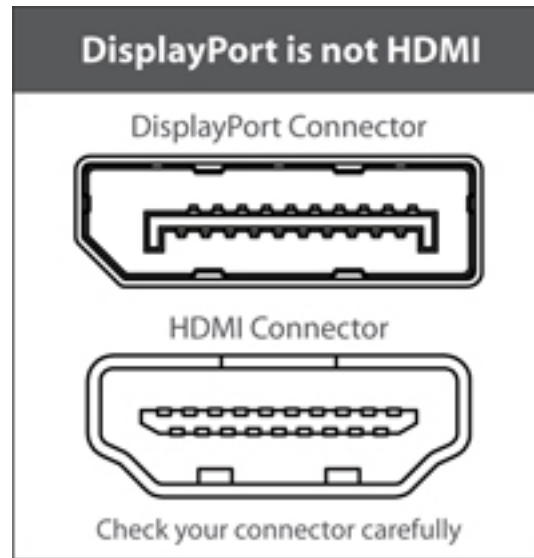

Applications and Solutions

- Ideal for multimedia design, post-production and video editing using Mac or PC computers
- Provide centralized control for multiple high-res Digital Signage server control
- Useful in high resolution medical imaging and Health care displays, such as MRI and Xray display
- Good for manufacturing line computer control, simplifying access to multiple systems
- Great for PC test/burn-in computer control saving the desk space required for two monitors, keyboards and mice
- Dual system control for single user workstations increasing user productivity in the office
- Consolidate your Satellite Topography systems into a single console

Features

- StarTech.com is the first to introduce a DisplayPort KVM into the Market
- OS independent - No driver or software installation required
- Supports native DisplayPort computer connections - no adapter required
- Hot-key and push-button switching
- Compatible with Mini-DisplayPort adapters
- Native resolution: 2560 x 1600 @ 60Hz, beyond 1080p
- Supports a maximum resolution of 3840 x 2400 at lower refresh rates
- 7.1 Channel High Definition Audio support
- USB 2.0 peripheral sharing
- Full plug-and-play support with USB keyboards, mice, and connected peripherals
- Supports hot-plug or disconnect and link status-failure detection
- VESA and CEA compliant
- User-defined scan time intervals
- Supports DDC2B for monitor detection
- Direct Drive support

Technical Specifications

- Warranty: 3 Year warranty
- Number of KVM Ports: 2
- Shipping (Package) Weight: 2.96 lb [1.34 kg]
- Supported Platforms: USB
- Color: Black
- Enclosure Type: Steel
- Audio Support: Yes
- Maximum Digital Resolutions: 2560 x 1600 @ 60Hz
- Wide Screen Supported:: Yes
- DVI Support: Yes - Dual Link
- LED Indicators: 2 - Green - Online indicator (One LED per port)
- LED Indicators: 2 - Red - Select indicator (One LED per port)
- Port Selection Support: Push Button and Hotkeys
- Console Interface(s): 1 - 20 pin DisplayPort Female
- Console Interface(s): 3 - USB A Female
- Host Interface(s): 2 - 20 pin DisplayPort Female
- Host Interface(s): 2 - USB B Female
- Power Adapter Included: Yes
- Input Voltage: 115 AC
- Output Voltage: 5 DC
- Output Current: 2000mA
- Center Tip Polarity: Positive
- Plug Type: M
- Product Width: 4.96 in [126 mm]
- Product Depth: 2.56 in [65 mm]
- Product Height: 1.57 in [40 mm]
- Product Weight: 0.92 lb [0.42 kg]
- Carton Quantity: 6
- OS Compatibility: OS independent; No software or drivers required

