

Long Range USB VGA KVM Console Extender over Cat5 UTP - 1000 ft

Product ID: SV565UTPUL



The SV565UTPUL Long Range USB VGA KVM Console Extender over Cat5 UTP (1000 ft) lets you control a server, computer or multiple computers (connected through KVM Switch) over a standard Cat5 or Cat6 UTP network cable connection, at distances of up to 1000ft (300m) away.

You can use your existing USB keyboard, USB mouse, and monitor to access both the server room and your office computer, saving space and avoiding the need for a dedicated remote console by allowing you to switch between workstation view and KVM view at the remote location.

This product is TAA compliant and backed by a Startech.com 3-year warranty with free lifetime technical support.

The SV565UTPUL gives you long range control of any VGA + USB computing device:

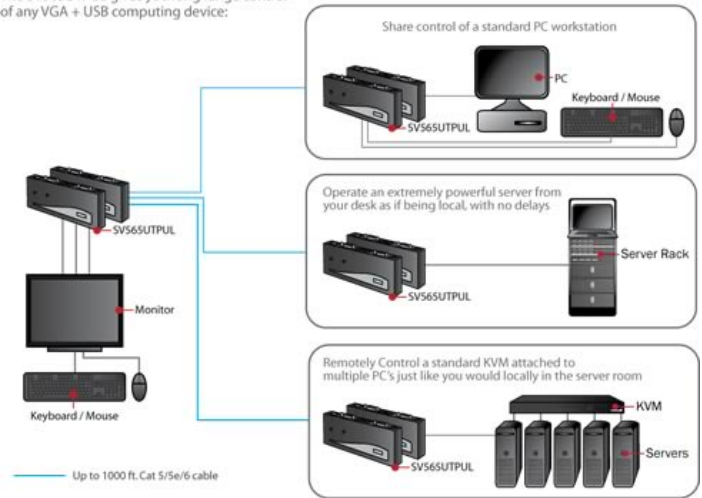

Certifications, Reports and Compatibility



Applications

- Control remote machines and security monitoring systems
- Monitor computer-controlled equipment in a factory or warehouse at a distance
- Use one or more servers in a server room from a remote location
- Allow two users to share one PC or KVM

Features

- High resolution support: Up to 1920x1200(WUXGA)/1600x1200(UXGA)
- Kit includes both local and remote units
- Compatibility mode enables hotkey commands to be passed to connected StarView KVMs
- Max Resolution Limit feature caps the resolution to prevent the resolution setting from exceeding the capability of the connected display
- USB computers are supported at the host and remote locations (USB keyboard and mouse required for remote console)
- Supports auto-switching between host and remote users or dedicated control
- Compatible with CAT 5, 5e, or 6 UTP cabling
- Intuitive hotkey commands
- Hotkey controlled Equalizer(sharpness), Gain(brightness), and RGB Skew adjustments
- Supports most combo keyboard and mouse sets (including Wireless)
- PS/2 and USB host PC's supported via the appropriate PS2 or USB KVM cable (USB style included)

Hardware	Warranty	3 Years
	Audio	No
	Cables Included	Yes
	KVM Ports	2
	Number of Monitors Supported	1
	PC Interface	USB
	PC Video Type	VGA
	Rack-Mountable	No
Performance	IP Control	No
	Max Transfer Distance	300 m (984 ft)
	Maximum Analog Resolutions	UXGA - 1600x1200, WUXGA - 1920x1200
	Port Selection Support	Push Button and Hotkeys
	Wide Screen Supported	Yes
Connector(s)	Console Interface(s)	2 - VGA (15 pin, High Density D-Sub) Female 4 - USB Type-A (4 pin) USB 2.0 Female
	Host Connectors	2 - VGA (15 pin, High Density D-Sub) Female
	Other Interface(s)	2 - RJ-45 Female
Software	OS Compatibility	OS independent; No software or drivers required
Special Notes / Requirements	Note	Supports most combo keyboard and mouse sets (including Wireless)
Indicators	LED Indicators	2 - Local indicator
		2 - Remote indicator
Power	Center Tip Polarity	Positive
	Input Current	0.8A
	Input Voltage	110V-240V AC
	Output Current	1.5A
	Output Voltage	12 DC
	Plug Type	M
	Power Consumption (In Watts)	18
	Power Source	AC Adapter Included
Environmental	Humidity	0~80% RH
	Operating Temperature	0°C to 40°C (32°F to 104°F)

	Storage Temperature	-20°C to 60°C (-4°F to 140°F)
Physical Characteristics	Color	Black
	Enclosure Type	Steel
	Product Depth	2.8 in [70 mm]
	Product Height	0.8 in [20 mm]
	Product Weight	22 oz [622 g]
	Product Width	6.2 in [157 mm]
Packaging Information	Shipping (Package) Weight	60 oz [1700 g]
What's in the Box	Included in Package	2 - KVM Extenders (1x Local, 1x Remote)
		2 - 2n1 USB VGA KVM Cables
		1 - Rubber Feet
		1 - Universal power adapter: comes ready for NA/EU/UK only when you buy in NA/EU/UK; comes ready for Australia and New Zealand only when you buy in Australia and New Zealand
		1 - User Manual

Product appearance and specifications are subject to change without notice.